



### Description

The SBA is a tensile type load cell of steel material. Suitable for tensile scale, tensile material testing machines.

### Features

- ▶ Tensile type
- ▶ Designing according to IP65

### Option

- ▶ Obtaining OIML C3 Approved (OIML R60)
- ▶ Acquiring NTEP class III 5000d Approved
- ▶ Rod end bearing type accessories  
(25-100 kgf: M6 x 1.0)  
(200-1tf: M12 x 1.75)  
(2-5tf: M18 x 1.5)

### Application

- ▶ Material tester
- ▶ Tensile testing machine

### Specifications

| Capacity(R.L.)                | kgf           | 25, 50, 100, 200, 500, 1K, 2K, 3k, 5K |           |
|-------------------------------|---------------|---------------------------------------|-----------|
| Rated Output                  | mV / V        | 3.0 ± 0.3                             |           |
| Zero Balance                  | mV / V        | 0.0 ± 0.03                            |           |
| Accuracy Class                | -             | C3                                    | -         |
| Non-Linearity                 | % R.O.        | ≤0.02                                 | ≤0.03     |
| Hysteresis                    | % R.O.        | ≤0.02                                 | ≤0.03     |
| Combined Error                | % R.O.        | ≤0.02                                 | ≤0.03     |
| Repeatability                 | % R.O.        | ≤0.01                                 | ≤0.01     |
| Creep for 30min.              | % R.O.        | ≤0.017                                | ≤0.03     |
| Return for 30min.             | % R.O.        | ≤0.017                                | ≤0.03     |
| Resolution                    | -             | ≤1/5000                               | ≤1/3000   |
| Division                      | mV / V        | 0.0006                                | 0.001     |
| Temperature Effect on         | -Zero Value   | %/10°C                                | ≤0.028    |
|                               | -Output Value | %/10°C                                | ≤0.015    |
| Excitation                    | -Recommended  | V                                     | 10        |
|                               | -Maximum      | V                                     | 15        |
| Resistance                    | -Input        | Ω                                     | 400 ± 3.5 |
|                               | -Output       | Ω                                     | 350 ± 3.5 |
|                               | -Insulation   | MΩ                                    | > 2000    |
| Compensated Temperature Range | °C            | -10 to +40                            |           |
| Operating Temperature Range   | °C            | -30 to +80                            |           |
| Material & Plate              | -             | Steel                                 |           |
| Cable Specification           | -             | Ø5.4 x 4P x 3m (Urethane)             |           |
| Safety Overload               | % R.L.        | 150                                   |           |

### Dimensions

- ▶ SBA

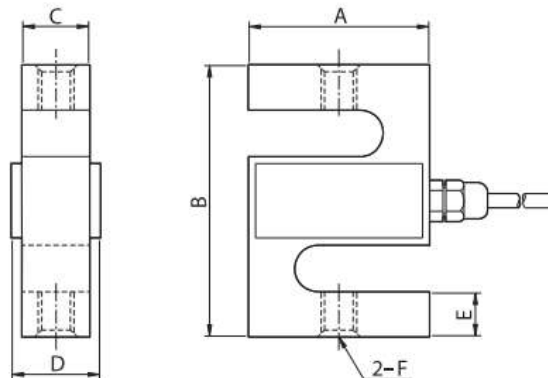

| Capa.      | A    | B    | C    | D  | E    | F          | Cable (m) |
|------------|------|------|------|----|------|------------|-----------|
| 25-100kgf  | 50.8 | 63.5 | 12.7 | 20 | 10.3 | M6 X 1     | 3         |
| 200-500kgf | 51   | 76   | 19   | 27 | 12.6 | M12 X 1.75 |           |
| 1tf        | 51   | 76   | 25.4 | 33 | 12.6 | M12 X 1.75 |           |
| 2-3tf      | 77   | 108  | 25.4 | 33 | 19   | M18 X 1.5  |           |
| 5tf        | 77   | 108  | 25.4 | 33 | 19.5 | M18 X 1.5  |           |