

# CPA

## Slim Profile Load Cell



P/F

Truck

### LOAD CELL



### DIMENSION

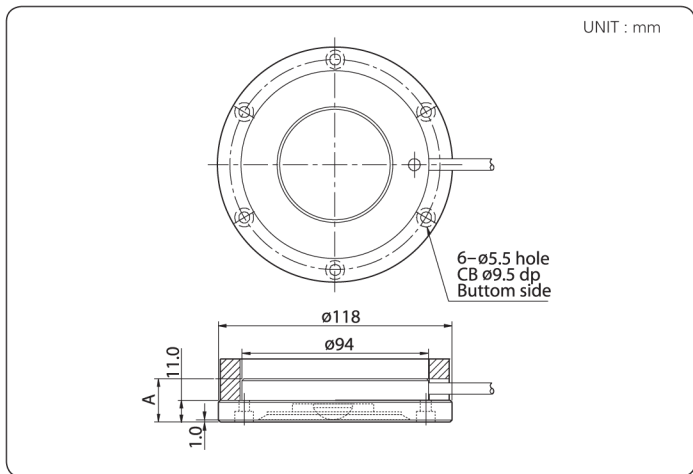

### FEATURES

- Low profile
- Integrated loading base
- Low deck high capacity scale application
- Nickel plated steel construction

### ACCESSORY OPTION

- No accessory

### SPECIFICATION

Capa.	A
500kgf	20
1tf	20
2tf	22
3tf	22
5tf	22

Capacity		kgf	500, 1K, 2K, 3K, 5K
Rated Output		mV / V	1.7 ± 0.17
Zero Balance		mV / V	0.0 ± 0.016
Accuracy Class		-	D3
Non-Linearity		% R.O.	≤ 0.14
Hysteresis		% R.O.	≤ 0.14
Combined Error		% R.O.	≤ 0.14
Repeatability		% R.O.	≤ 0.03
Creep for 30min.		% R.O.	≤ 0.03
Return for 30min.		% R.O.	≤ 0.03
Resolution		-	≤ 1/700
Division		mV / V	0.0024
Temperature Effect on	-Zero Value	%/10°C	≤ 0.03
	-Output Value	%/10°C	≤ 0.05
Excitation	-Recommended	V	10
	-Maximum	V	15
Resistance	-Input	Ω	760 ± 7
	-Output	Ω	700 ± 7
	-Insulation	MΩ	> 2000
Compensated Temperature Range		°C	- 10 to + 40
Operating Temperature Range		°C	- 40 to + 70
Material & Plate		-	Nickel plated steel
Cable Specification		-	ø4 x 4P x 0.62M (P.V.C)
Safety Overload		% R.L.	150% R.L.
Platform Size		mm	No Platform type