

# LSW

## Low Profile Center Hole



### LOAD CELL



### DIMENSION

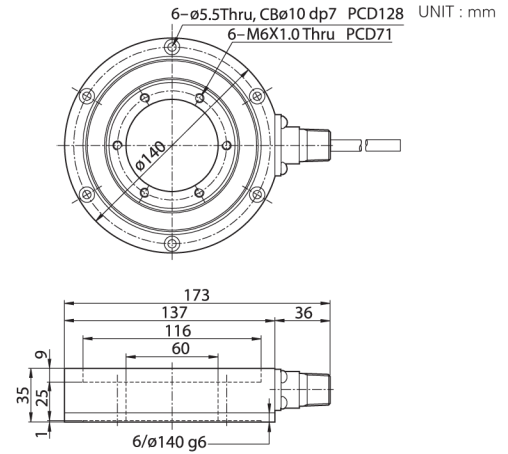

### FEATURES

- Steel construction
- Center hole compression Load Cell
- Low profile

### SPECIFICATION

Capacity		tf	1, 3
Rated Output		mV / V	1.0 $\pm$ 0.05
Zero Balance		mV / V	0.0 $\pm$ 0.015
Accuracy Class		-	-
Non-Linearity		% R.O.	$\leq$ 0.05
Hysteresis		% R.O.	$\leq$ 0.05
Combined Error		% R.O.	$\leq$ 0.05
Repeatability		% R.O.	-
Creep for 30min.		% R.O.	$\leq$ 0.03
Return for 30min.		% R.O.	$\leq$ 0.03
Resolution		-	< 1/200
Division		mV / V	0.005
Temperature Effect on	-Zero Value	%/10°C	$\leq$ 0.05
	-Output Value	%/10°C	$\leq$ 0.05
Excitation	-Recommended	V	10
	-Maximum	V	15
Resistance	-Input	$\Omega$	350 $\pm$ 3.5
	-Output	$\Omega$	350 $\pm$ 3.5
	-Insulation	M $\Omega$	> 2000
Compensated Temperature Range		°C	- 10 to + 40
Operating Temperature Range		°C	- 20 to + 80
Material & Plate		-	Steel
Cable Specification		-	$\phi$ 8.0 x 4P x 10M
Safety Overload		% R.L.	150% R.L.
Platform Size		mm	No Platform type